

***Notes:**
 - Internal layouts, roof plant layouts and fit out to be confirmed by tenants
 - Occupancy levels to be confirmed with tenants and to be in line with Building Regulations regarding Fire Escape capacity

Key
 ↗ +0.00 m AOD denotes proposed spot level dimension
 ↘ +0.00 m AOD denotes existing spot level dimension

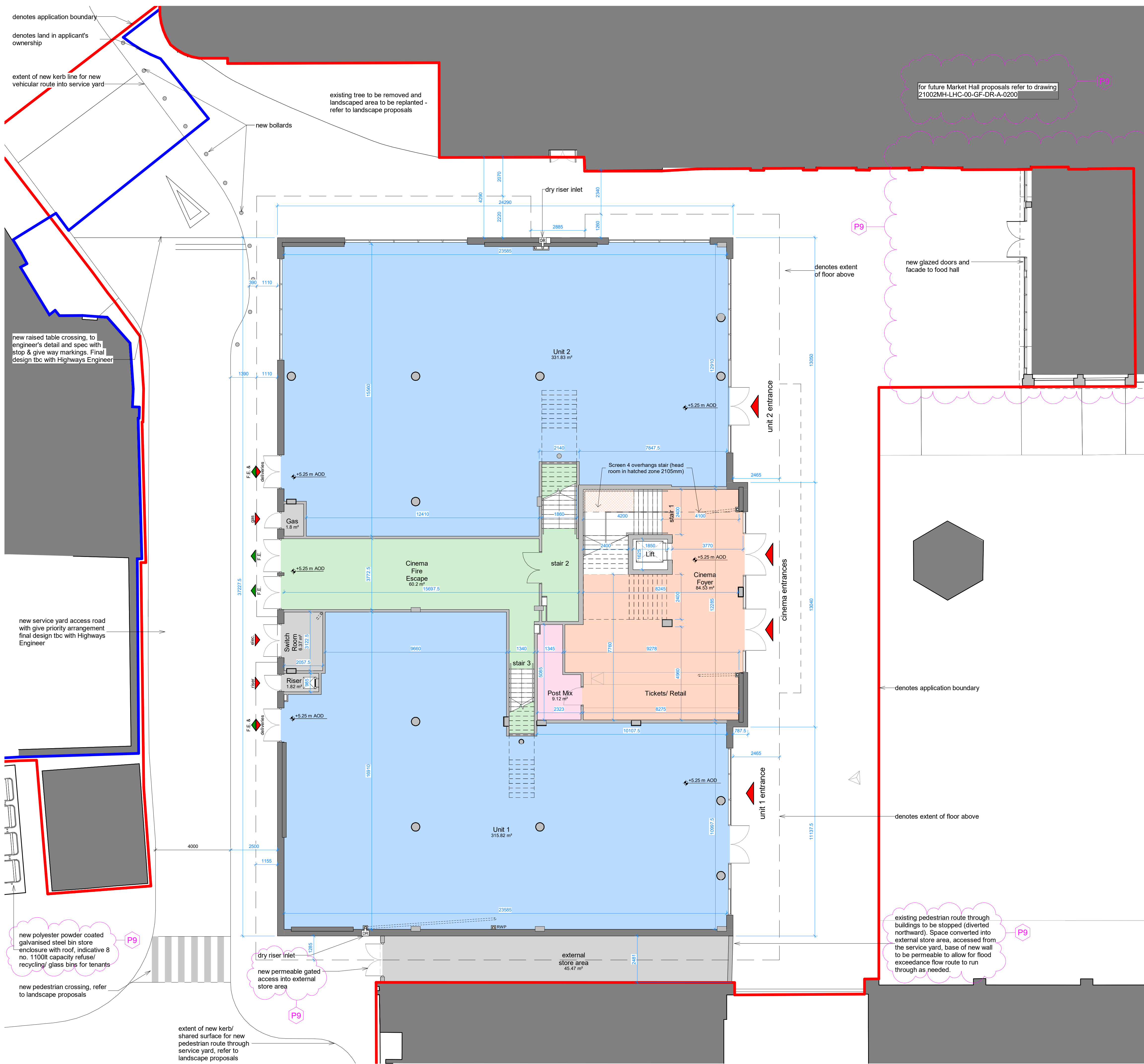

REV	DATE	COMMENT	AUTH/CHKD
P9	17/10/22	Location of new glazed facade to Market Hall amended to align with new future proposals for existing building, reference to separate drawing added, annotations updated	CC/AL
P8	12/07/22	Bins store and indicative bins shown for clarity - issued for Planning	CC/AL
P7	01/06/22	PLANNING ISSUE	CC/AL
P6	26/05/22	Structural model inserted, scheme revisions to incorporate Client comments. Issued for Client review and approval leading to Planning Application Issue	CC/AL
P5	18/10/19	Pre-application Issue	CC/AL
P4	29/03/19	Feature window & external signage amended as per clients comments	MO/CC
P3	22/03/19	Stage 2 Issue	MO/CC
P2	20/02/19	Scheme Development, general updates	MO/CC
REV	DATE	COMMENT	AUTH/CHKD

PROJECT TITLE
 Newton Abbot Cinema

DETAIL
 Proposed GA Plans – Ground Floor

DRAWING NUMBER (PROJECT-ORIGINATOR-ZONE-LEVEL-TYPE-ROLE-NUMBER)
 17029NAC - LHC - 00 - GF - DR - A - 0201

STATUS	STATUS DESCRIPTION
D0	Planning

REVISION	DATE	SCALE
P9	Feb '19	1 : 100@A1

CONTRACTORS MUST CHECK ALL DIMENSIONS ON-SITE - ONLY FIGURED DIMENSIONS ARE TO BE WORKED FROM - DISCREPANCIES MUST BE REPORTED TO THE ARCHITECT BEFORE PROCEEDING
 © THIS DRAWING IS COPYRIGHT

lhc design

EXETER 01302 444334
 PLYMOUTH 01752 669368
 ST AUSTELL 01892 852201
 lhc.net

